

## Combination Rapid Induction Fixed Supply and Non-Ducted Return Plenum Slot Diffuser

Imperial [IP] Dimensions  
Metric (SI) in Parentheses

CARNES COMPANY 448 S. Main St., P. O. Box 930040, Verona, WI 53593-0040 Phone: (608)845-6411 Fax: (608)845-6504 www.carnes.com

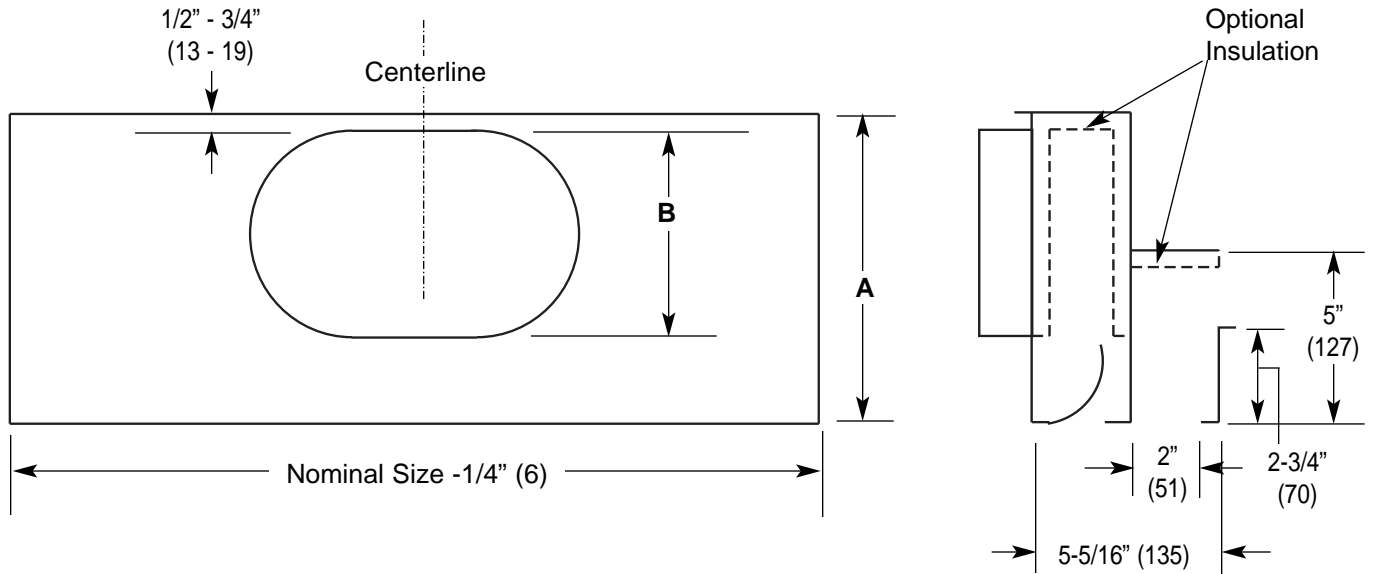

Nom. Neck Size	Inlet Height (Dim. B)	Unit Height (Dim. A)
5" (127)		
6" (152)	3-1/2" (89)	8" (203)
7" (178)		
8" (203)		
10" (254)	6" (152)	9" (229)
12" (305)		

**Notes:**

- 24 gauge galvaneal steel construction.
- Standard color is #06 Flat Black.
- For surface mounting use model KXFBA Auxiliary Mounting Frame.
- Metric (SI) dimensions are shown in millimeters.
- When specified, insulation is 1/2", 2-pound density matte-finish fiberglass, internally mounted.
- Standard nominal lengths are 24" (610), 36" (914), 48" (1219) and 60" (1524).

**Detail of Diffuser Face**

Deflector is offset downward to be flush with face of ceiling grid.

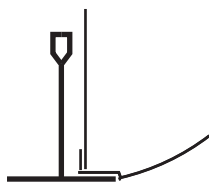

**Optional Inlet Damper**

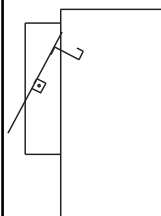

**Center Down Blow Option "D"**

When specified, the center of the diffuser is equipped with a down blow deflector, while the ends of the diffuser remain equipped with the standard deflector for this diffuser. This option is available on lengths 36" (914) and over.

