

Model AVCA — Open-End

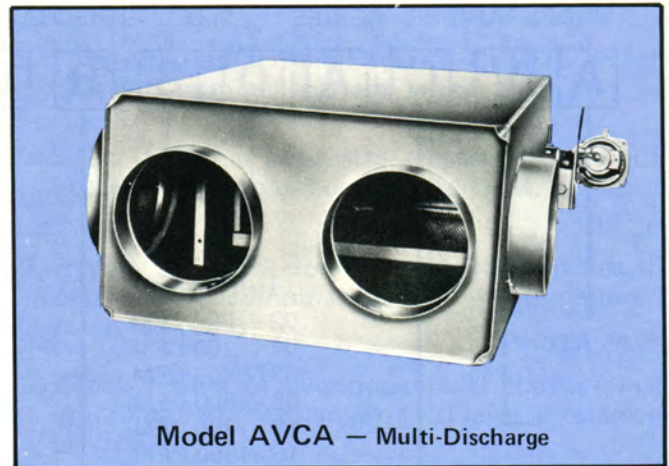

Model AVCA — Multi-Discharge

The Carnes Model AVCA, throttling control terminal unit, is available in open-end and multi-discharge configurations. By use of the patented throttling valve, these units offer low pressure drop, low sound levels, and linear valve characteristics which create stable control conditions within the conditioned space.

Other features include:

- Air flow capacities to 6000 CFM.
- Pneumatic, electric, or manual damper control.
- Thermally and acoustically insulated casing.
- Open-end discharge units are provided with S and drive connection for easy installation.
- Multi-discharge units have round or elliptical outlet connections with integral balancing dampers.
- Air flow sensor at inlet of unit.
- Hanger brackets for easy mounting characteristics.

Model Numbering System — AVCA EXTERNALLY POWERED

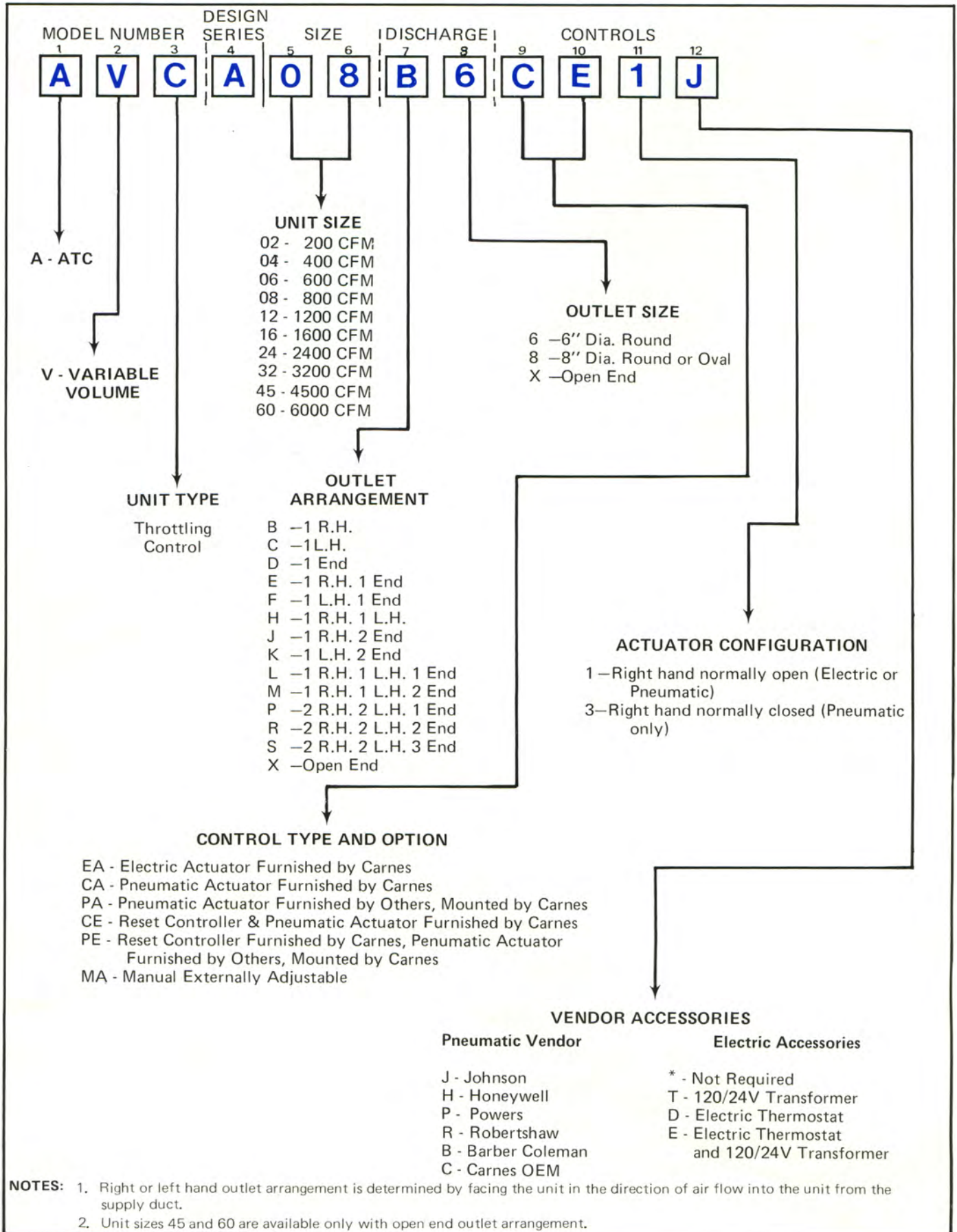

2 Dimensional Data

OPEN END DISCHARGE

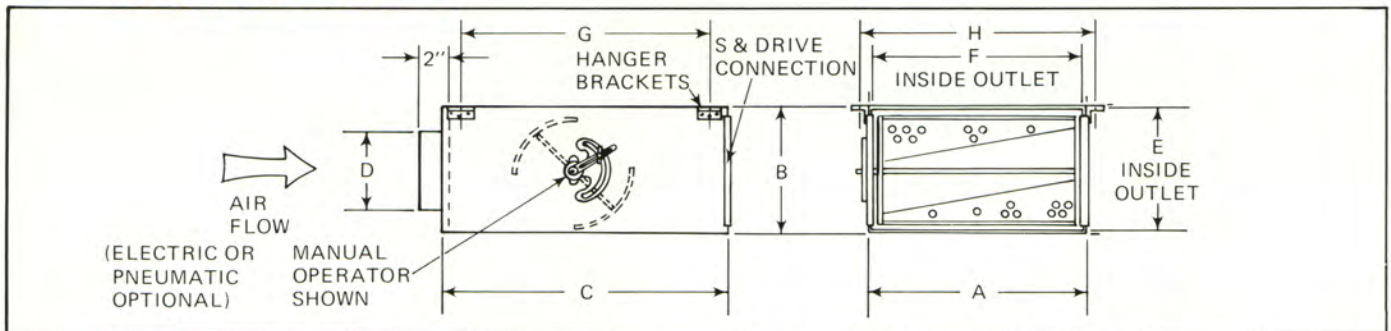

Size	CFM	A (Inches)	B (Inches)	C (Inches)	D (Inches)	S & Drive Outlet		G (Inches)	H (Inches)	Weight Lbs.
						E (Inches)	F (Inches)			
02	200	13	8	23-3/4	5	8	13	20	14	20
04	400	13	8	23-3/4	6	8	13	20	14	20
06	600	14	10	23-3/4	7	10	14	20	15	22
08	800	17	10	23-3/4	8	10	17	20	18	26
12	1200	20	12	27	10	12	20	23-1/4	21	32
16	1600	22	14	29	12	14	22	25-1/4	23	40
24	2400	26	16	31	14	16	26	27-1/4	27	58
32	3200	32	18	43	16	18	32	39-1/4	33	77
45	4500	32	18	43	20 x 16	18	32	39-1/4	33	77
60	6000	32	18	43	24 x 16	18	32	39-1/4	33	77

MULTI-DISCHARGE

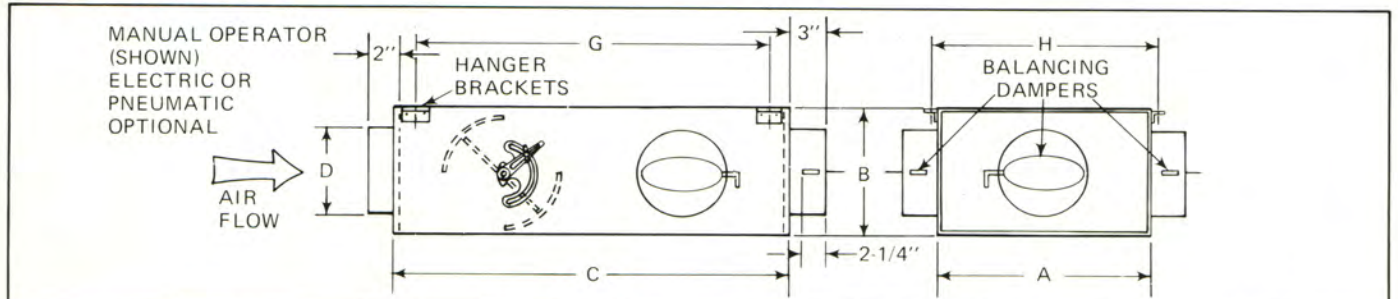

Size	CFM	A (Inches)	B (Inches)	C (Inches)	D (Inches)	G (Inches)	H (Inches)	Weight Lbs.
02	200	13	8	23-3/4	5	20	14	22
04	400	13	8	23-3/4	6	20	14	22
06	600	14	10	23-3/4	7	20	15	24
08	800	17	10	23-3/4	8	20	18	28
12	1200	20	12	27	10	23-1/4	21	35
16	1600	22	14	29	12	25-1/4	23	46
24	2400	26	16	31.41*	14	27-1/4	27	64
32	3200	32	18	43	16	39-1/4	33	88

Outlet Arrangement (Top View)

Unit Size	B	E	J	L	M	P	R	S	XX Open End
02	6 or 8	6 or 8		6					Outlet Size Inches
04	6 or 8	6 or 8		6 or 8					
06	8	6 or 8		6 or 8					
08	8	6 or 8	6	6 or 8	6				
12		8	6 or 8	6 or 8	6 or 8				
16			8	8	8				
24					8	8	8		
32						8	8	8	

Note: 6 indicates 6" round.

8 indicates 8" round.

8 indicates 8" elliptical.

*41 inch dimension for P and R arrangements only.