

IP [English] Dimensions
SI (Metric) In Parentheses

CARNES COMPANY 448 S. Main St., P. O. Box 930040, Verona, WI 53593-0040 Phone: (608)845-6411 Fax: (608)845-6504 www.carnes.com



DESCRIPTION

Nema 4X disconnect switch, watertight and dust-tight, non-fused, 30 Amp, single or three phase (120V - 600V AC), front operated, bottom hinged enclosure, one factory installed auxiliary contact.

DIMENSIONAL DIAGRAM

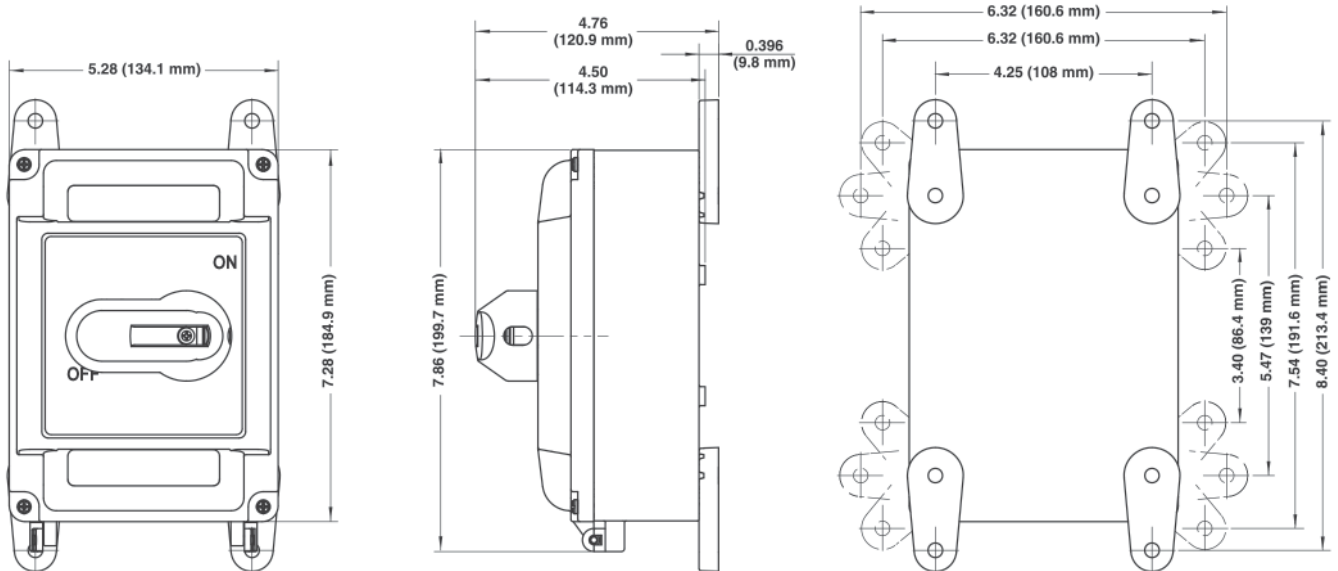

JTNA FEATURES

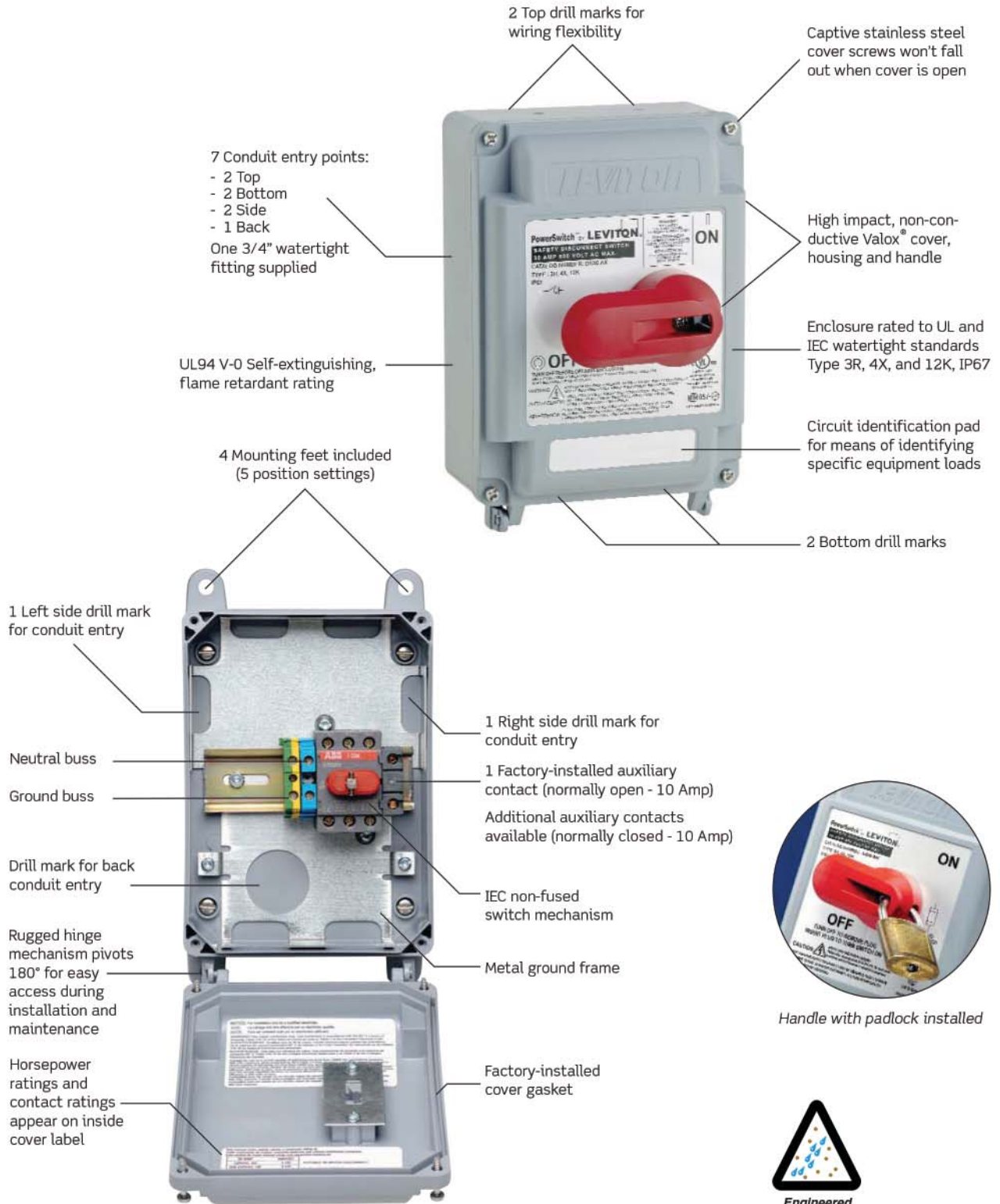

Standards & Certifications				
UL 508 Non-Fused	cULus	NOM	CE	IEC 947-3
	✓	✓	✓	✓

JTNA DISCONNECT SWITCH SPECIFICATIONS
UL 508 (non-fused) Listed
cUL per CSA Specification C22.2 No. 14



**Interrupting Ratings —
RMS Symmetrical Amperes**

Non-fused are suitable for use on circuits capable of delivering not more than (see chart below for cat. no. and value) RMS symmetrical amperes.

AMPS	MAX VOLTAGE	RMS SYMMETRICAL AMPS
30	600V AC	10,000 Amp

*Meets 2002 NEC® Requirements
430.102 (A) and 430.102 (B)*

Electrical				Mechanical		Environmental	
Ground Path Integrity	Device	Current Applied	Duration	Mold Stress Relief	70°C for 7 hours	Flammability	V-2 or better per UL 94 or CSA 22.2 No. 0.6; V-0 for watertight enclosure
	30 A	60 A	2 min.	Knockout Test	Remains in place with 20 lbs. push	Rain (3R) per UL 50	Water spray @ 5 psi from all sides for 1 hr.
				Crush	100 lb.	Hosedown (4X) per UL 50	Water spray @ 65 gal/min. for 5 minutes
Current Interrupting	Certified for current interrupting at full-rated current and voltage			Impact	1.2 lb. steel ball dropped from 5 ft.	Dust (12K) per UL 50	Cement dust circulated @ 1000 ft./minute for 5 minutes
				Cold Impact	Same as above, after conditioning to -35°C	Gasket Aging	70°C for 168 hours
Endurance	6000 operations at rated current and voltage (Power factor 0.75-0.80)			Strength of Insulating Base and Support	110% of specified tightening torque on terminal screws	UV Resistance	Exposed plastic materials are UV stabilized
Dielectric	1000 V plus twice rated voltage for 1 minute			Pullout	18 lb. pull on internal wires	Operating Temperature	-40°C to +65°C (-40°F to +140°F)

Max. HP Ratings Per UL 508	
VOLTS	
120V AC	2
208V AC	5
240V AC	5
480V AC	10
600V AC	NA
3ØY 120/208V AC	10
3Ø 240V AC	10
3Ø 480V AC	20
3Ø 600V AC	25

NA = Not Available